

ALUMINIUM FRAMES

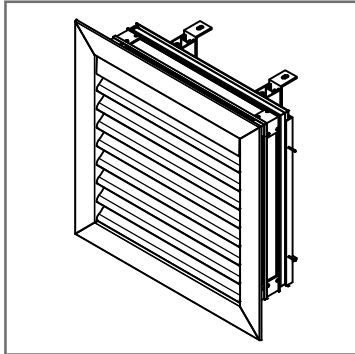

L.050W

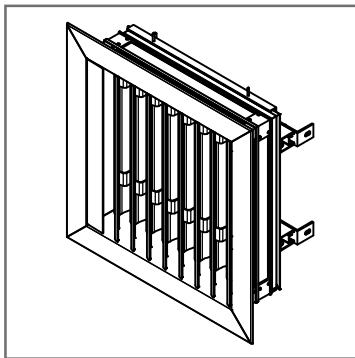

L.050WV

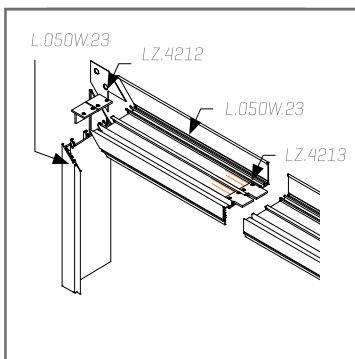

L.050W/ L.050WV

The high performant system L.050W can be provided with an optional frame profile L.050W.21 which will result in an ideal water drainage. This frame profile will be installed both horizontally and vertically around the wall opening and is used in combination with mullion profile LD.0460. These mullion profiles LD.0460, with pre-assembled clips L.050W.11, are to be installed onto structural mullions [type Renson® or a structural sub-structure] and provided with stainless steel mesh. In this way incoming water is drained back to the outside.

L.050W

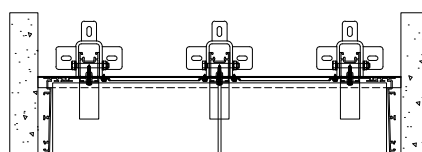
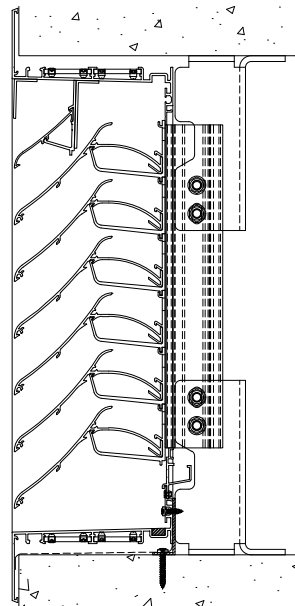
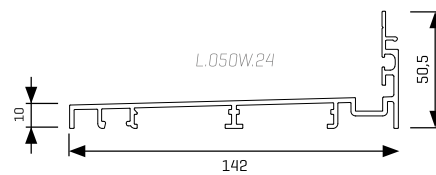
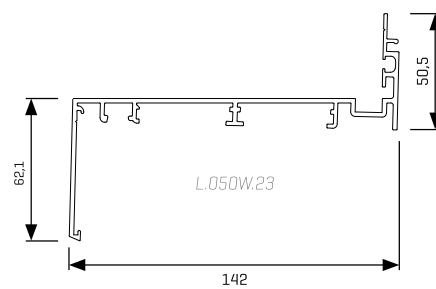

L.075W

The louvre system type 75 has been designed with the option of being provided with a frame with or without flange.

The design with flange gives the aesthetically attractive appearance of a continuous blade surface. A sealing rubber can be used to give the louvre a perfect finish so use of silicone putty is unnecessary.

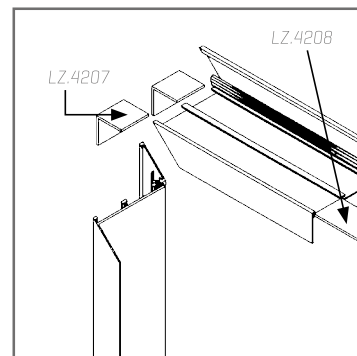
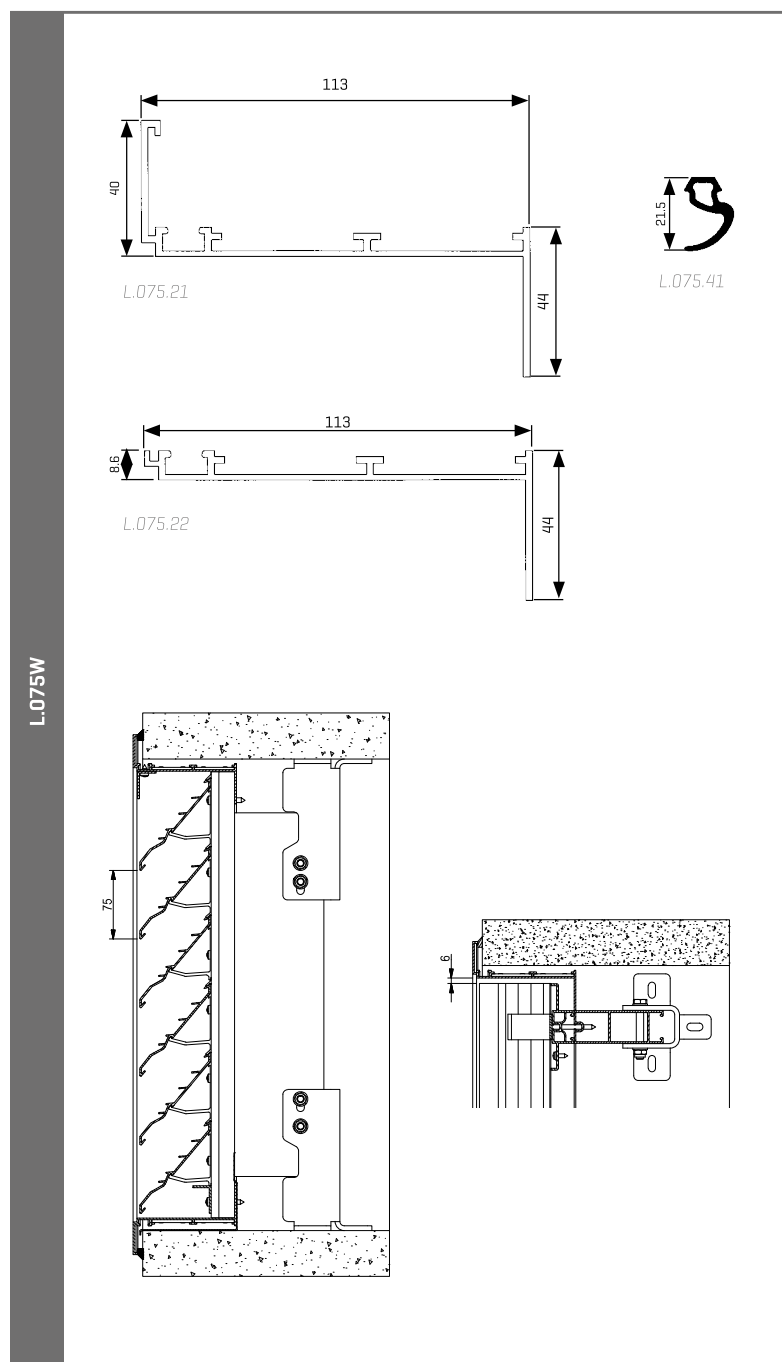

LZ.4207: Corner trim connector
LZ.4208: Intermediate trim connector

L.075W